

WHEEL FITMENT TEMPLATES

TOYOTA	C-HR	17~18	
PARTS NO.	ROTOR DIAMETER	FRONT/REAR	PCD
TO43-R	356mm X 32mm	REAR	5X114.3

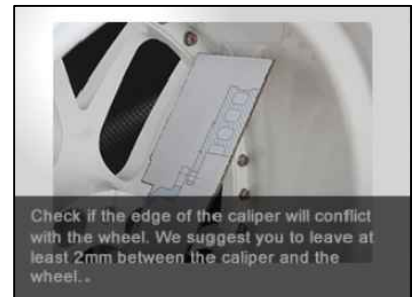
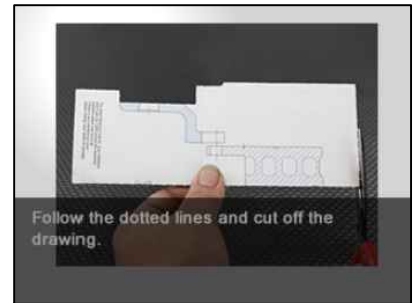
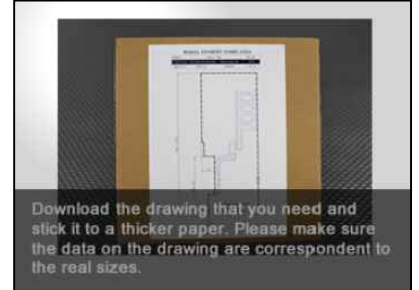
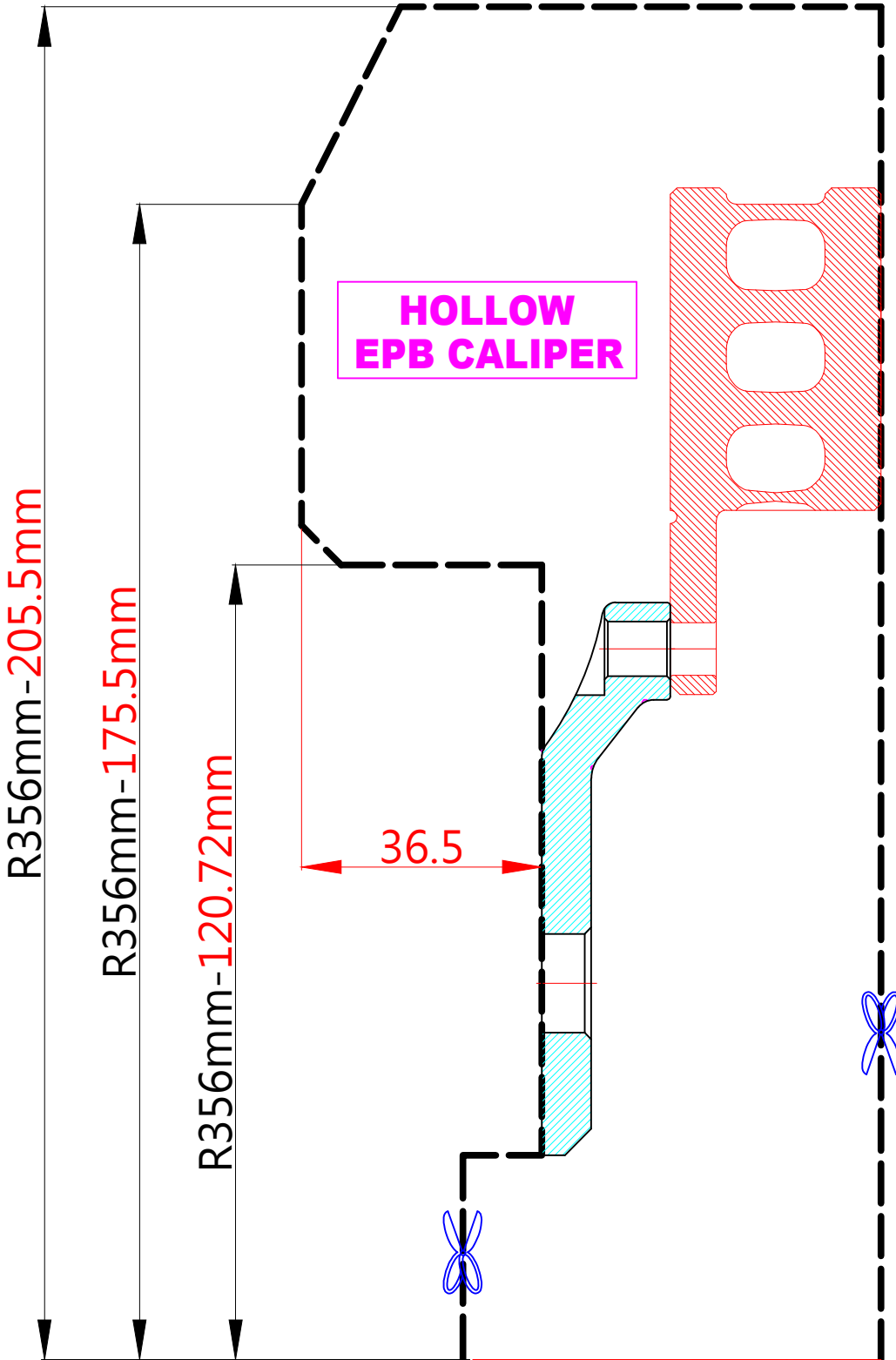

The wheel fitment is only for your reference and it can not 100% ensure the clearance between caliper and rim is ok. if there is any interference issue, please change your wheel as possible.