

WHEEL FITMENT TEMPLATES

TOYOTA	CALDINA 4WD	97~02	
PARTS NO.	ROTOR DIAMETER	FRONT/REAR	PCD
TO30	356mm X 32mm	FRONT	5X100

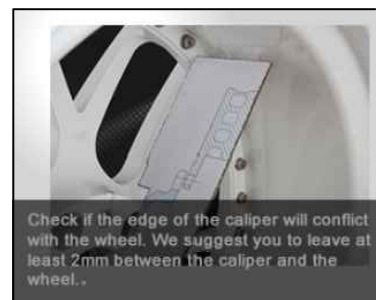
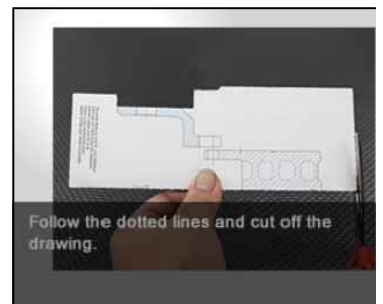
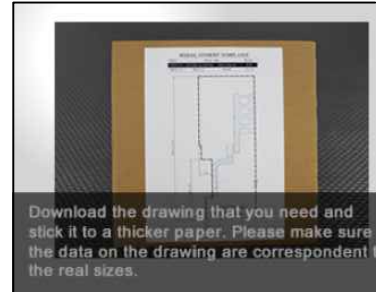
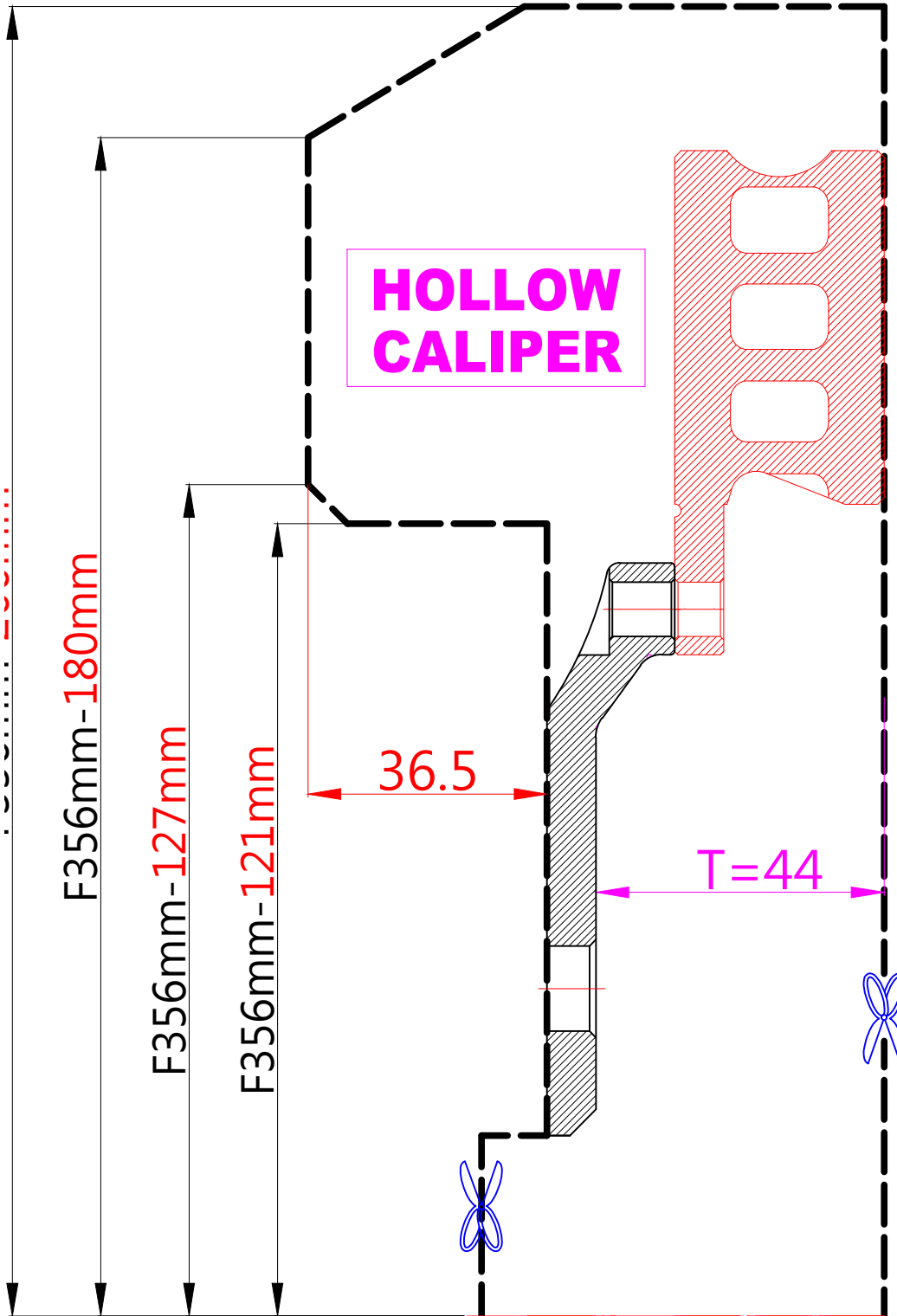

The wheel fitment is only for your reference and it can not 100% ensure the clearance between caliper and rim is ok. if there is any interference issue, please change your wheel as possible.