

WHEEL FITMENT TEMPLATES

NISSAN		SKYLINE R34 GTR		99~02
PARTS NO.	ROTOR DIAMETER	FRONT/REAR	PCD	
NI04-1-R	380mm X 32mm	REAR	5X114.3	

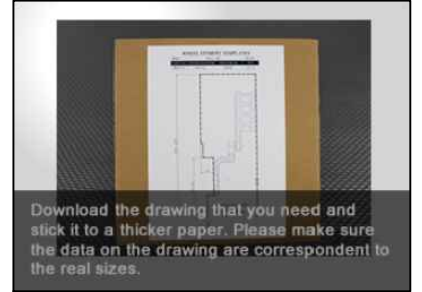
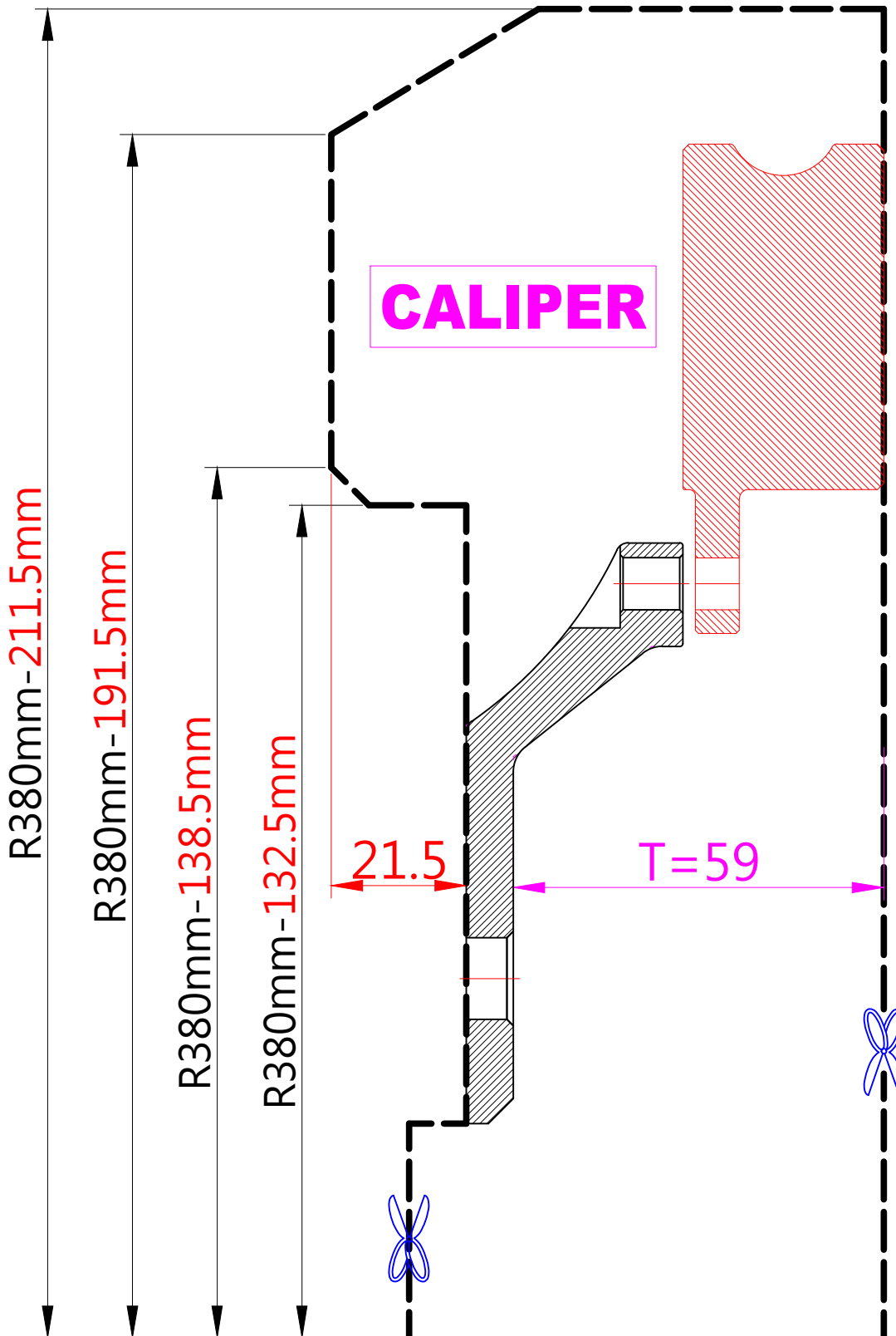

The wheel fitment is only for your reference and it can not 100% ensure the clearance between caliper and rim is ok. if there is any interference issue, please change your wheel as possible.