

WHEEL FITMENT TEMPLATES

MITSUBISHI		EVO10		08~16
PARTS NO.	ROTOR DIAMETER	FRONT/REAR	PCD	
MI015-1	356mm X 32mm	FRONT	5X114.3	

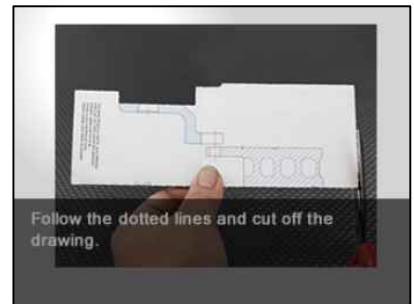
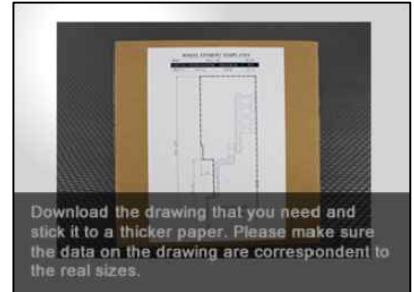
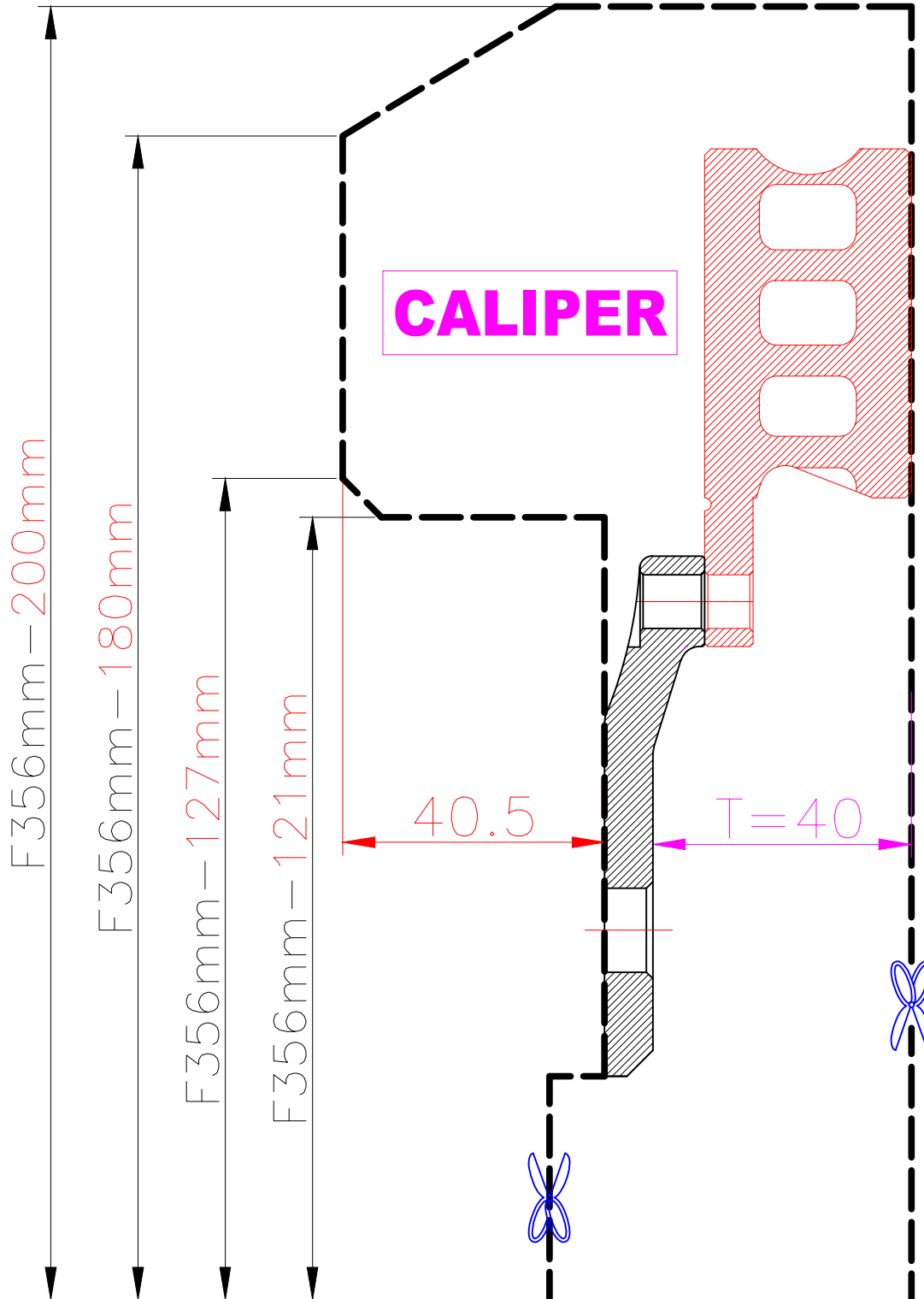

The wheel fitment is only for your reference and it can not 100% ensure the clearance between caliper and rim is ok. if there is any interference issue, please change your wheel as possible.