

WHEEL FITMENT TEMPLATES

| mitsubishi | | 3000GT (GTO) | | 90~96 | |
|-------------------|-----------------------|---------------------|----------------|--------------|--|
| PARTS NO. | ROTOR DIAMETER | FRONT/REAR | PCD | | |
| MI09 | 304mm X 28mm | FRONT | 5X114.3 | | |

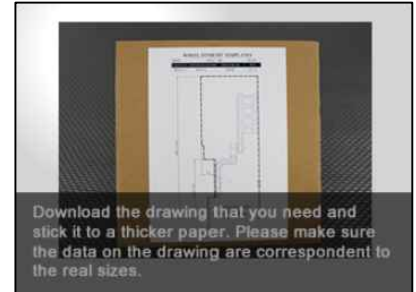
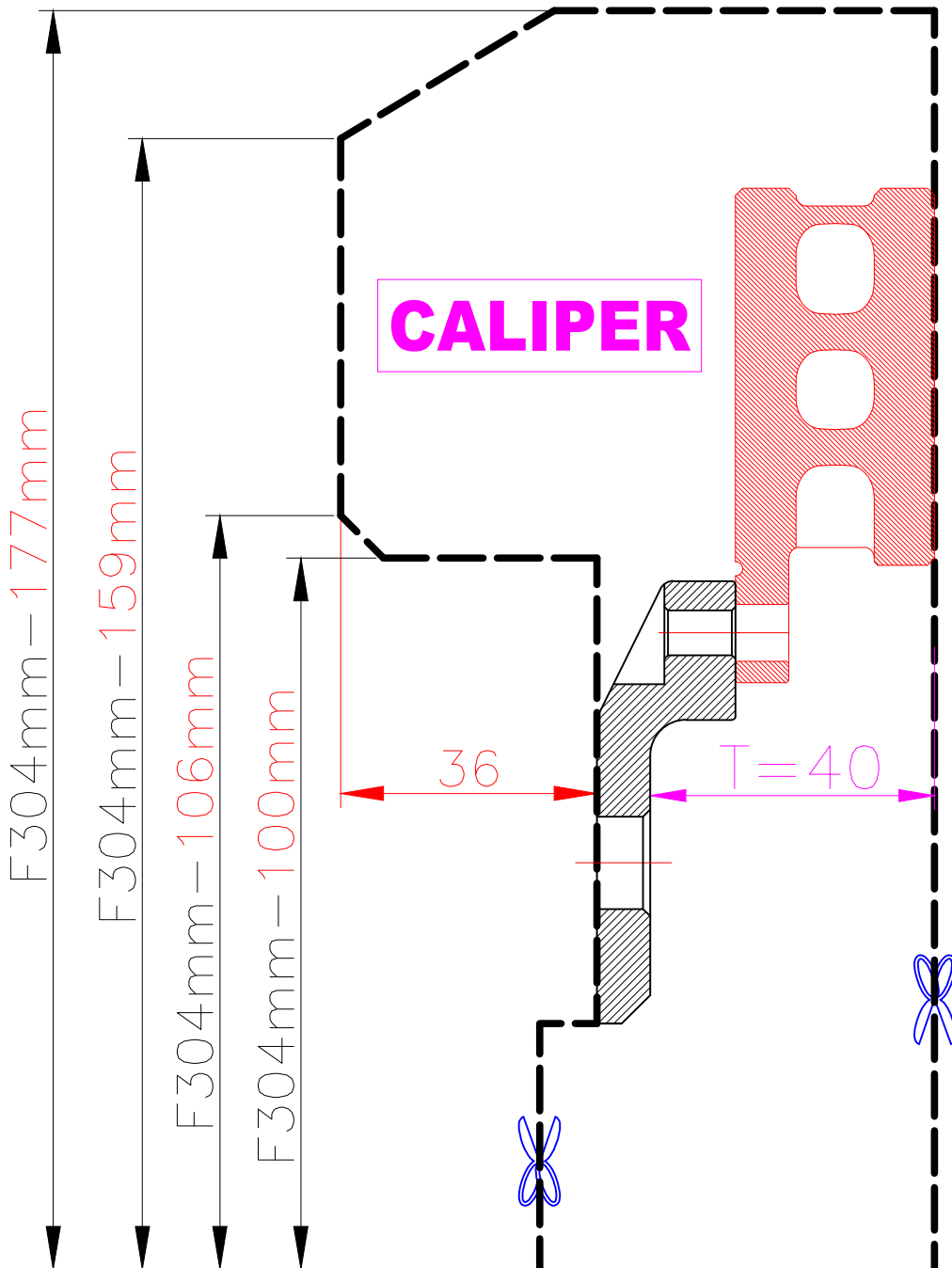

The wheel fitment is only for your reference and it can not 100% ensure the clearance between caliper and rim is ok. if there is any interference issue, please change your wheel as possible.