

# WHEEL FITMENT TEMPLATES

MAZDA	CX-5 (KF)	17~UP	
PARTS NO.	ROTOR DIAMETER	FRONT/REAR	PCD
MA20-1	380mm X 32mm	FRONT	5X114.3

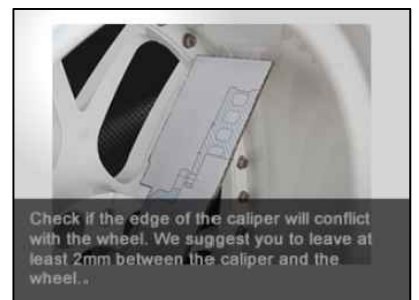
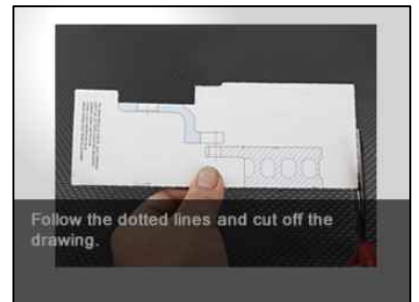
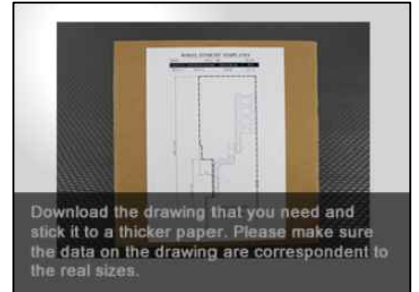
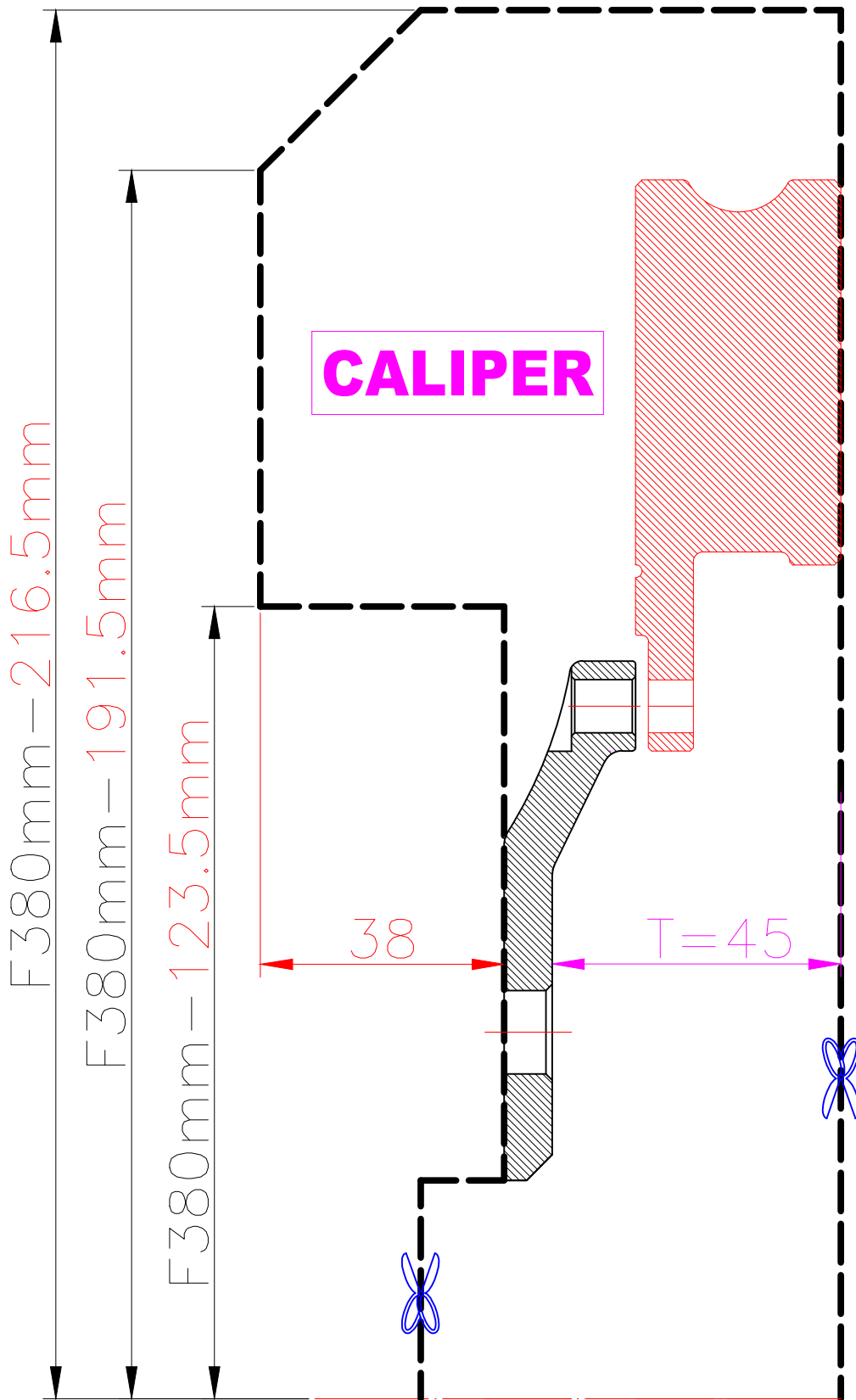

The wheel fitment is only for your reference and it can not 100% ensure the clearance between caliper and rim is ok. if there is any interference issue, please change your wheel as possible.