

WHEEL FITMENT TEMPLATES

MAZDA	MX-5	90~98
PARTS NO.	ROTOR DIAMETER	FRONT/REAR
MA07	286mm X 26mm	FRONT
		PCD
		4X100

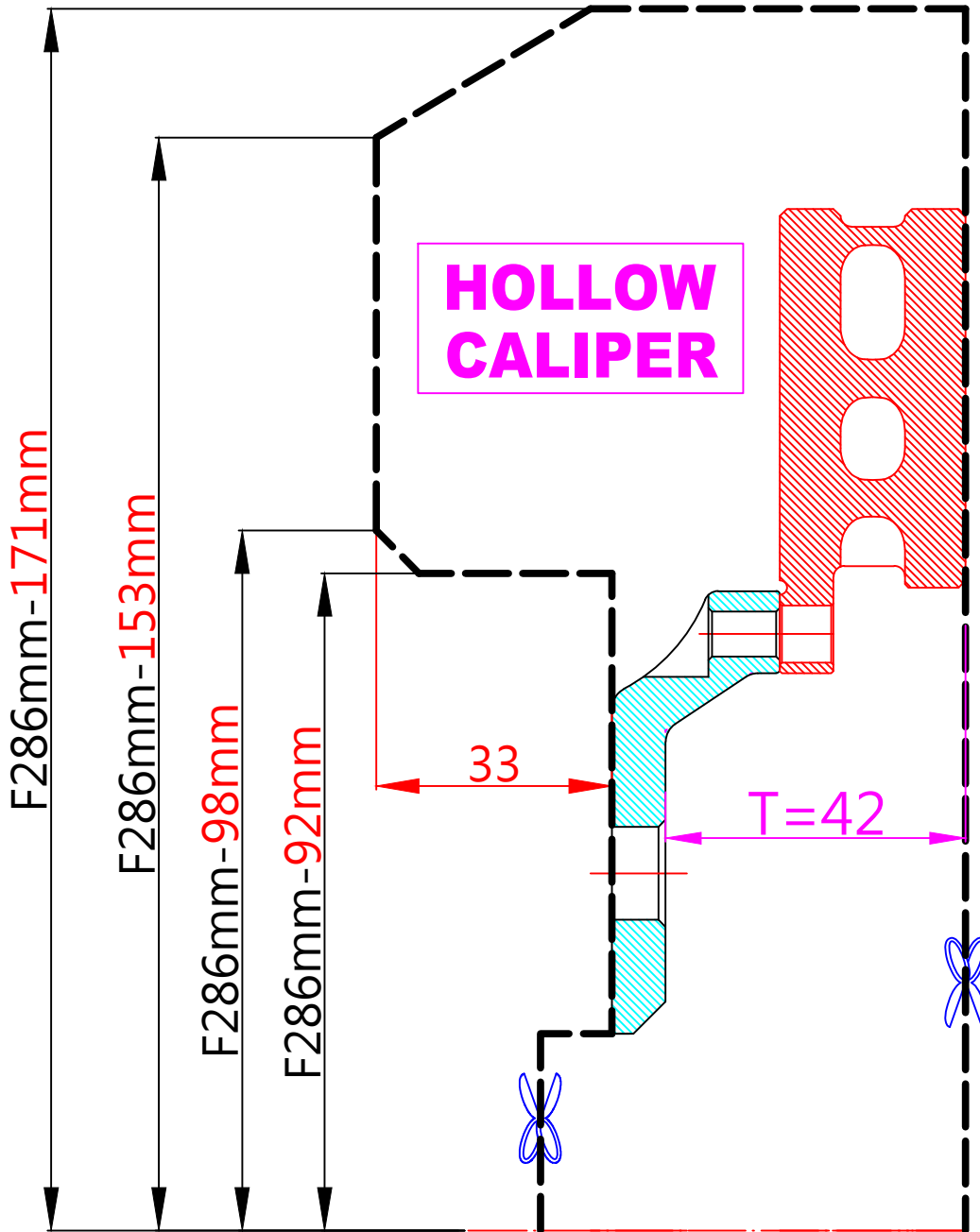

The wheel fitment is only for your reference and it can not 100% ensure the clearance between caliper and rim is ok. if there is any interference issue, please change your wheel as possible.