

# WHEEL FITMENT TEMPLATES

HONDA		CIVIC FC1 (JAPAN)		16~UP
PARTS NO.		ROTOR DIAMETER	FRONT/REAR	PCD
HO17-4		304mm X 28mm	FRONT	5X114.3

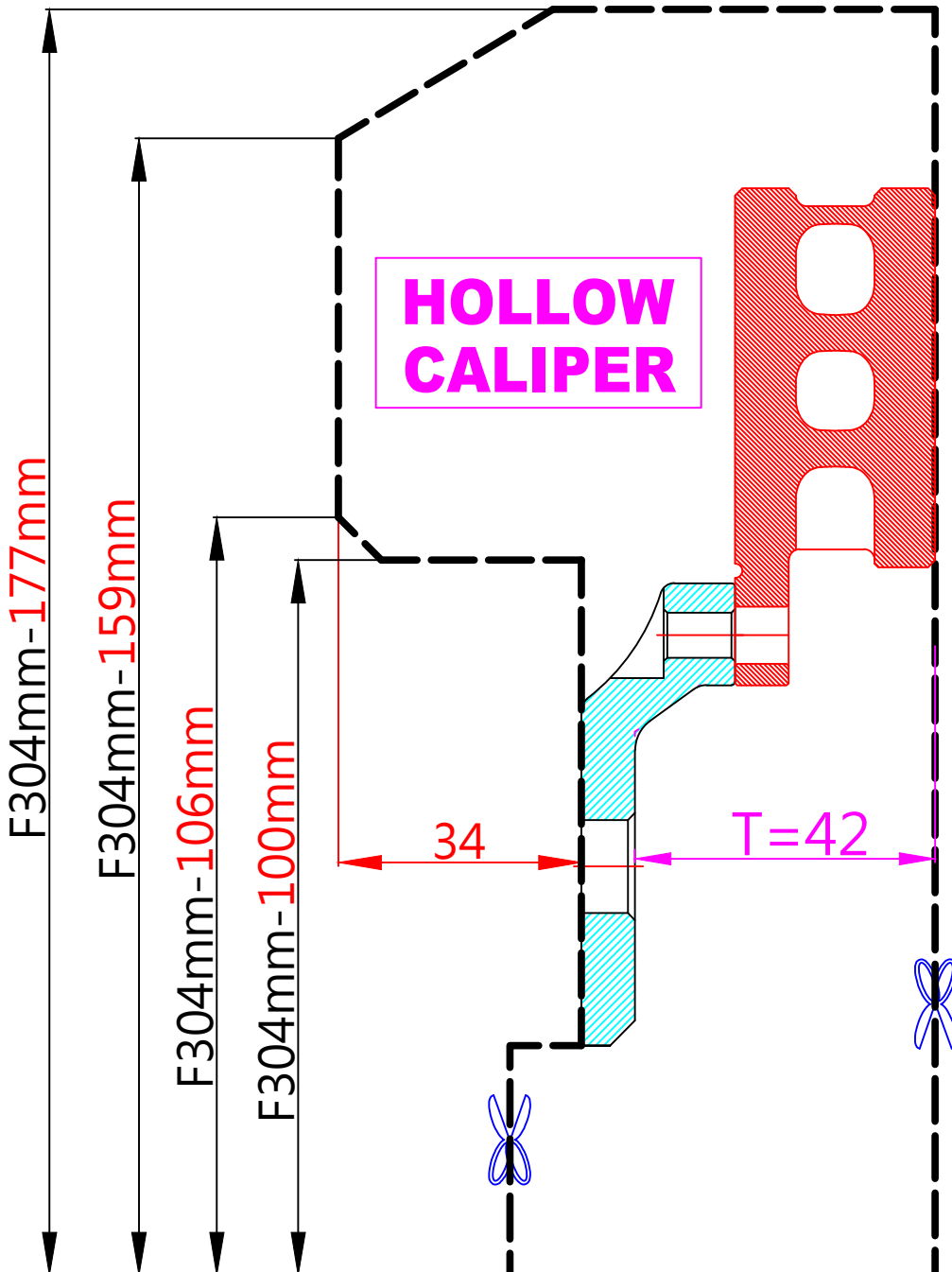

The wheel fitment is only for your reference and it can not 100% ensure the clearance between caliper and rim is ok. if there is any interference issue, please change your wheel as possible.