

WHEEL FITMENT TEMPLATES

MAZDA	3(BP)	19~UP	
PARTS NO.	ROTOR DIAMETER	FRONT/REAR	PCD
MA26	350mm X 22mm / 3POT	FRONT	5X114.3

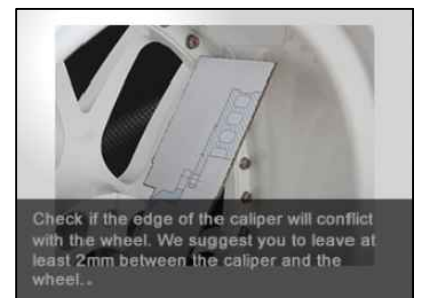
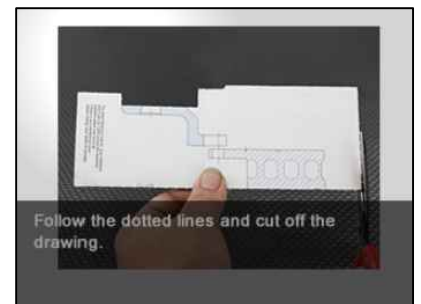
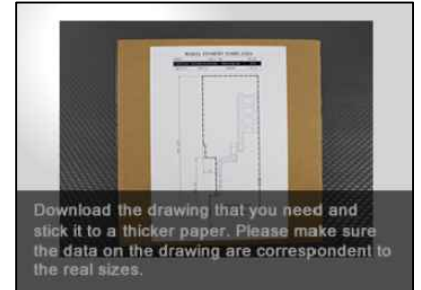
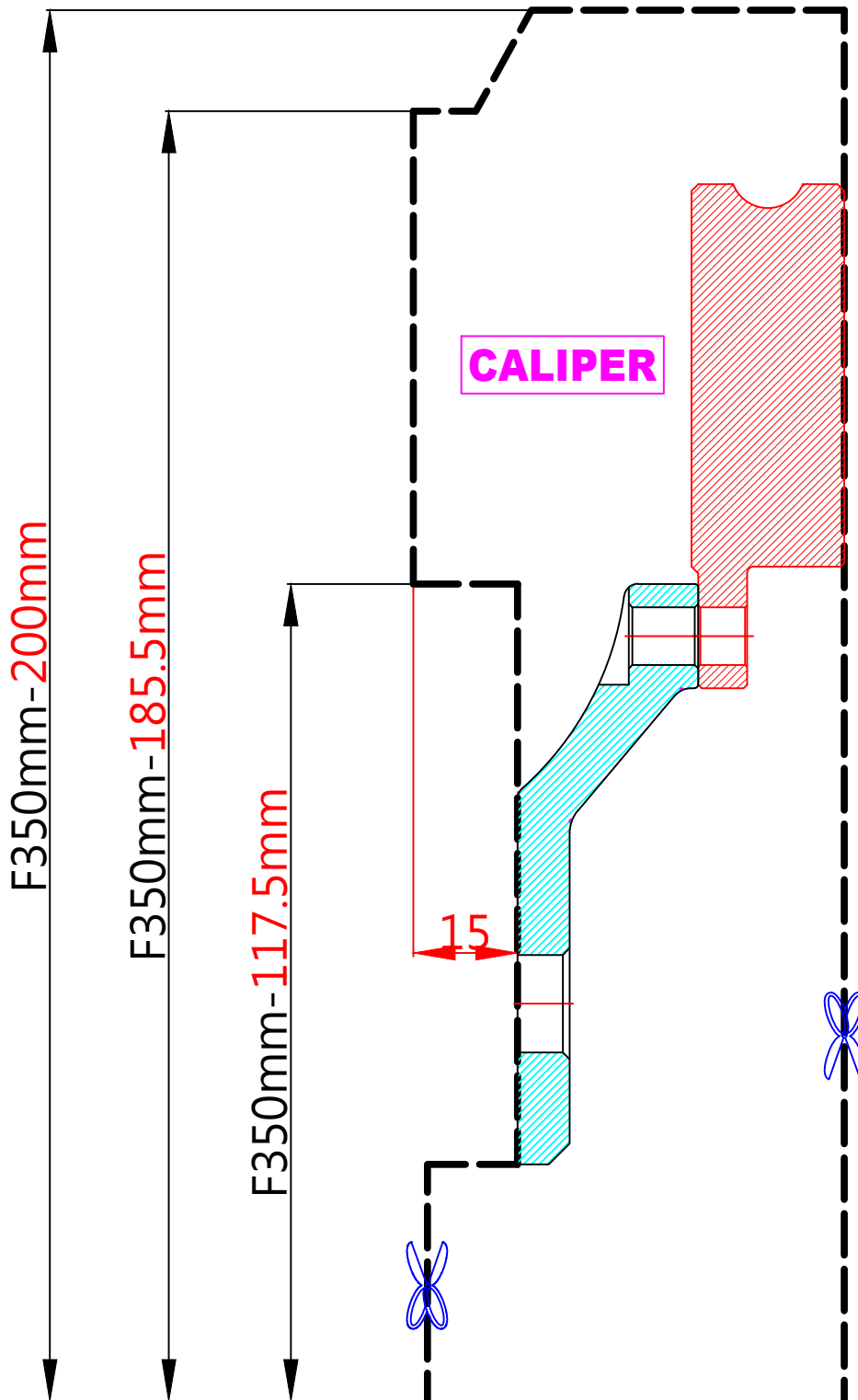

The wheel fitment is only for your reference and it can not 100% ensure the clearance between caliper and rim is ok. if there is any interference issue, please change your wheel as possible.