

# WHEEL FITMENT TEMPLATES

TOYOTA	IQ	08~15	
PARTS NO.	ROTOR DIAMETER	FRONT/REAR	PCD
TO25-3	330mm X 32mm	FRONT	4X100

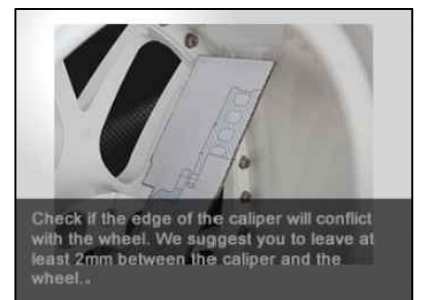
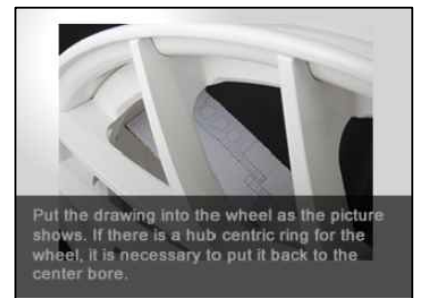
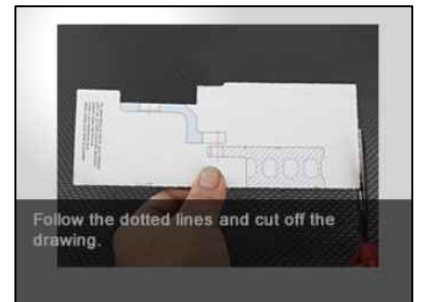
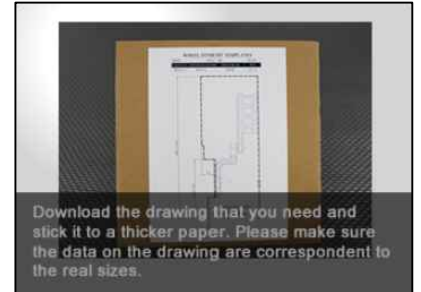
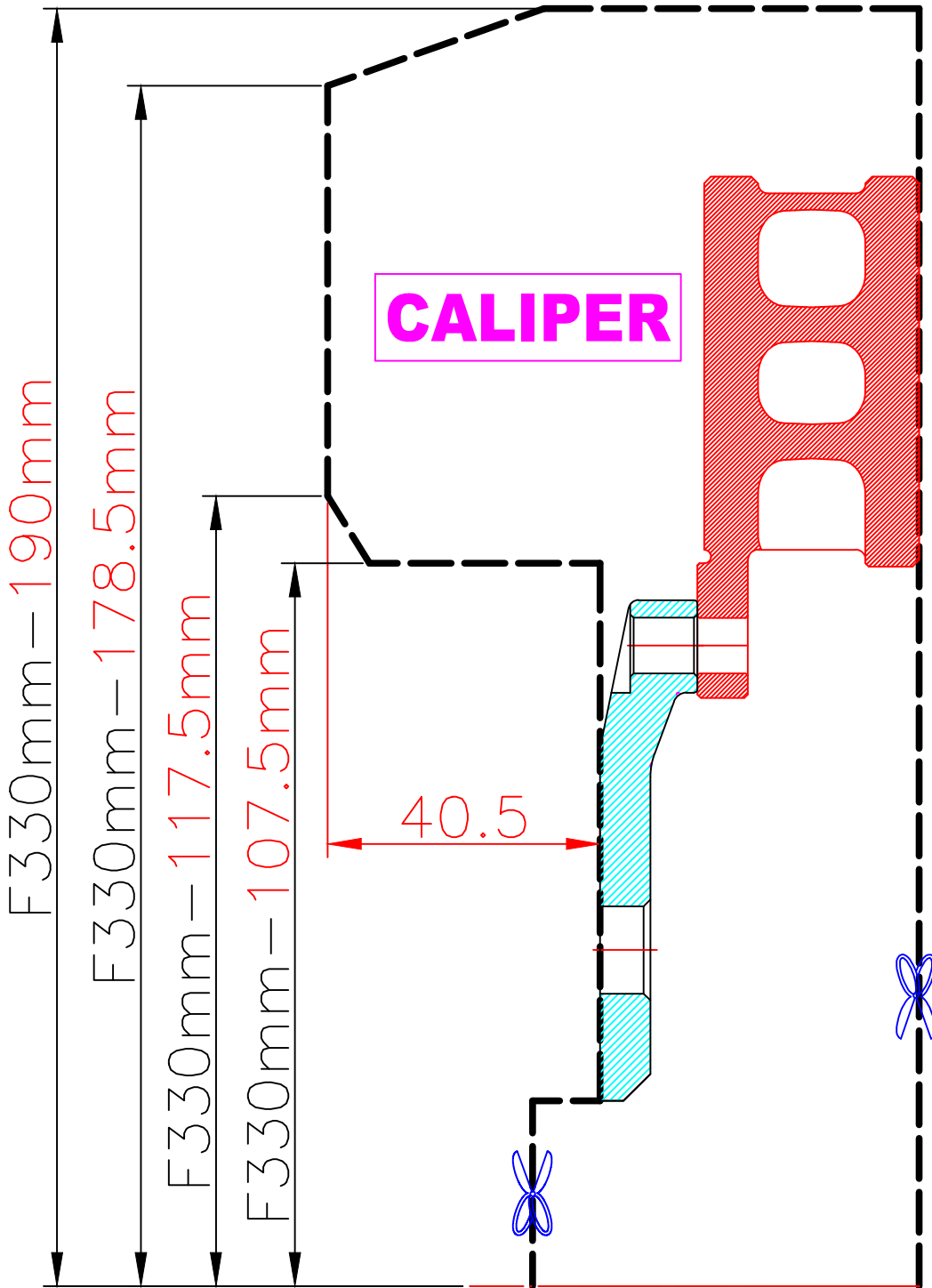

The wheel fitment is only for your reference and it can not 100% ensure the clearance between caliper and rim is ok. if there is any interference issue, please change your wheel as possible.