

WHEEL FITMENT TEMPLATES

HONDA		CIVIC EK TYPE-R		96~00
PARTS NO.	ROTOR DIAMETER	FRONT/REAR	PCD	
HO01-1-7	304 X 28	FRONT	5 X 114.3	

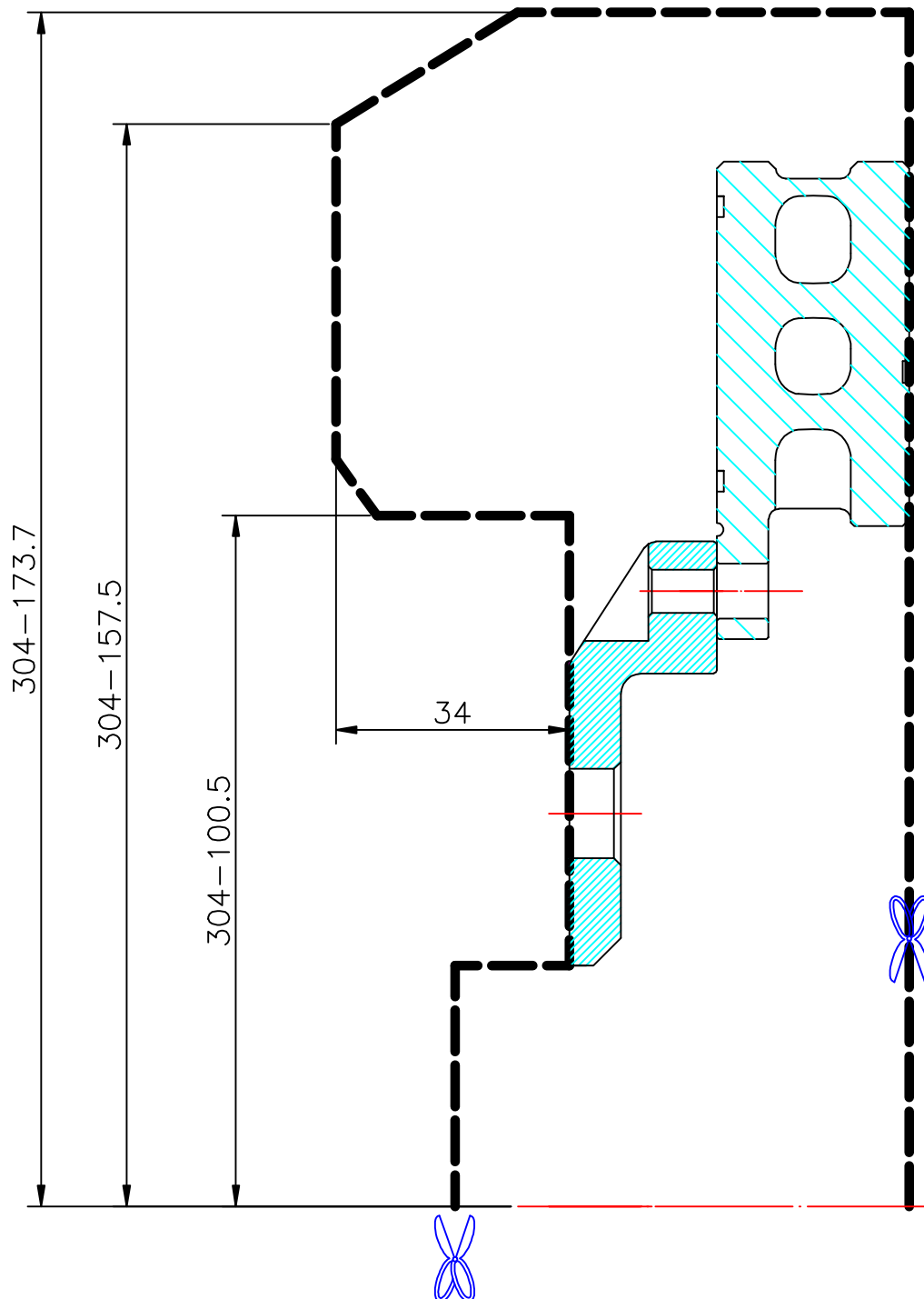

The wheel fitment is only for your reference and it can not 100% ensure the clearance between caliper and rim is ok. if there is any interference issue, please change your wheel as possible.