

WHEEL FITMENT TEMPLATES

BMW	F11	10~16	
PARTS NO.	ROTOR DIAMETER	FRONT/REAR	PCD
BM71-6-8	380 X 32	FRONT	5 X 120

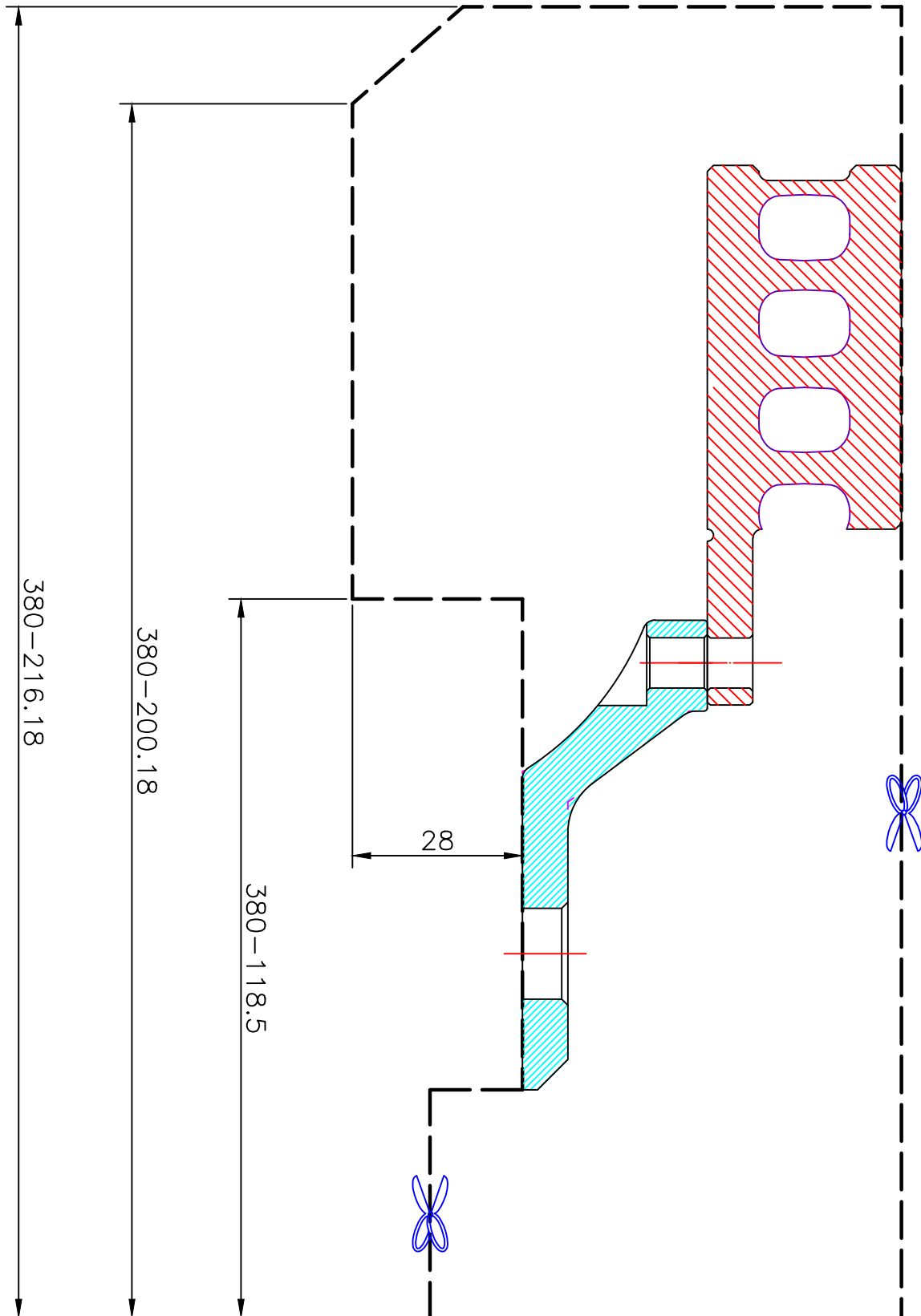

The wheel fitment is only for your reference and it can not 100% ensure the clearance between caliper and rim is ok. if there is any interference issue, please change your wheel as possible.