

# WHEEL FITMENT TEMPLATES

BMW	E 81 130	07~12	
PARTS NO.	ROTOR DIAMETER	FRONT/REAR	PCD
BM66-5-8	380 X 32	FRONT	5 X 120

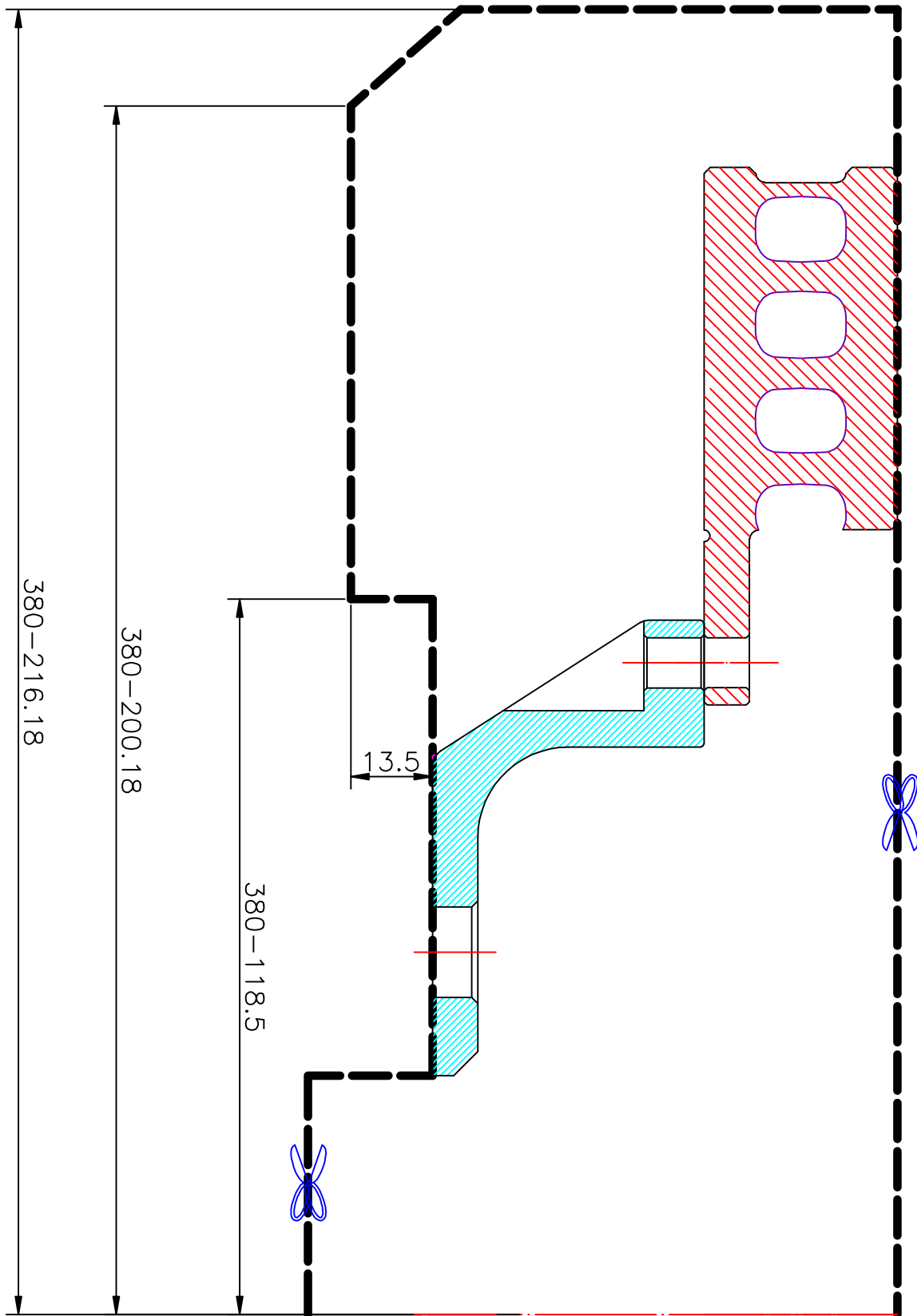

**The wheel fitment is only for your reference and it can not 100% ensure the clearance between caliper and rim is ok. if there is any interference issue, please change your wheel as possible.**